

Small Signal Switching Diodes

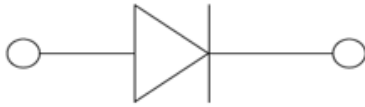

SOD123

Features

- Epoxy meets UL-94 V-0 flammability rating and halogen free
- Moisture Sensitivity Level 1
- V_{RRM} 120V to 250V
- I_{FAV} 200mA
- Part no. with suffix "Q" means AEC-Q101 qualified

Applications

- General Purpose Switches Diodes
- Automotive

Mechanical Data

- **Case:** SOD123
- **Terminals:** Tin plated leads, solderable per J-STD-002 and JESD22-B102
- **Polarity:** Cathode line denotes the cathode end

■ Maximum Ratings ($T_a=25^\circ\text{C}$ Unless otherwise specified)

PARAMETER	SYMBOL	UNIT	CONDITIONS	PART	VALUE
Reverse Voltage	V_R	V		BAV19WQ	100
				BAV20WQ	150
				BAV21WQ	200
Repetitive Peak Reverse Voltage	V_{RRM}	V		BAV19WQ	120
				BAV20WQ	200
				BAV21WQ	250
Average Forward Current	I_{FAV}	mA			200
Non-Repetitive Peak Forward Surge Current	I_{FSM}	A	$t_p < 10\text{ms}$		1.7
Power Dissipation	P_{tot}	mW			410
Thermal Resistance Junction to Ambient	R_{thJA}	K/W			305
Maximum Junction Temperature	T_j	$^\circ\text{C}$			150
Storage Temperature Range	T_{stg}	$^\circ\text{C}$			-55 to +150



BAV19WQ THRU BAV21WQ

■ Electrical Characteristics (T_a=25°C Unless otherwise specified)

PARAMETER	SYMBOL	UNIT	CONDITIONS		MIN	MAX
Reverse Voltage	V _R	V	BAV19WQ	I _R =100uA	100	
			BAV20WQ	I _R =100uA	150	
			BAV21WQ	I _R =100uA	200	
Forward Voltage	V _F	V	I _F =100mA			1.0
			I _F =200mA			1.25
Reverse Current	I _R	μA	BAV19WQ	V _R =100V		0.1
			BAV20WQ	V _R =150V		0.1
			BAV21WQ	V _R =200V		0.1
Diode Capacitance	C _D	pF	V _R =V _F =0V, f =1MHz			5
Reverse Recovery Time	t _{rr}	ns	I _F =30mA, I _{rr} =0.1I _R , R _L =100Ω			50

■ Ordering Information (Example)

PREFERED P/N	PACKING CODE	UNIT WEIGHT(g)	MINIMUM PACKAGE(pcs)	INNER BOX QUANTITY(pcs)	OUTER CARTON QUANTITY(pcs)	DELIVERY MODE
BAV19WQ THRU BAV21WQ	F2	Approximate 0.010	3000	30000	120000	7" reel



BAV19WQ THRU BAV21WQ

■ Characteristics (Typical)

Fig.1: P_D-T_A

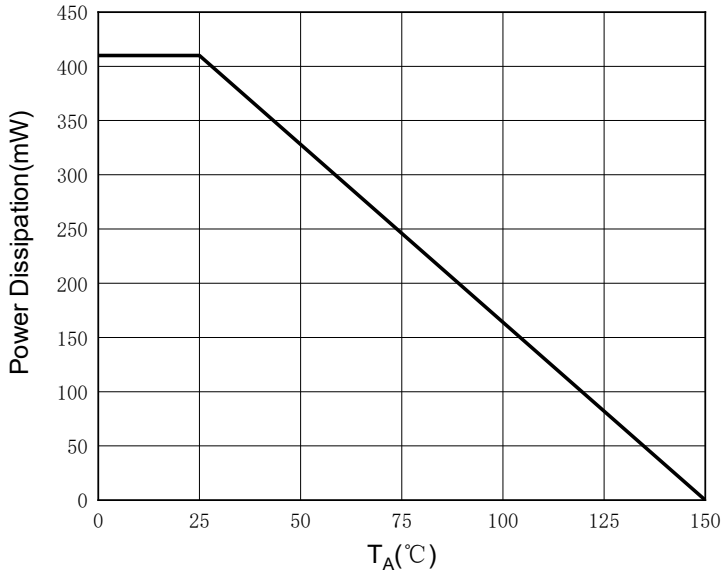

Fig.2: Forward Characteristics

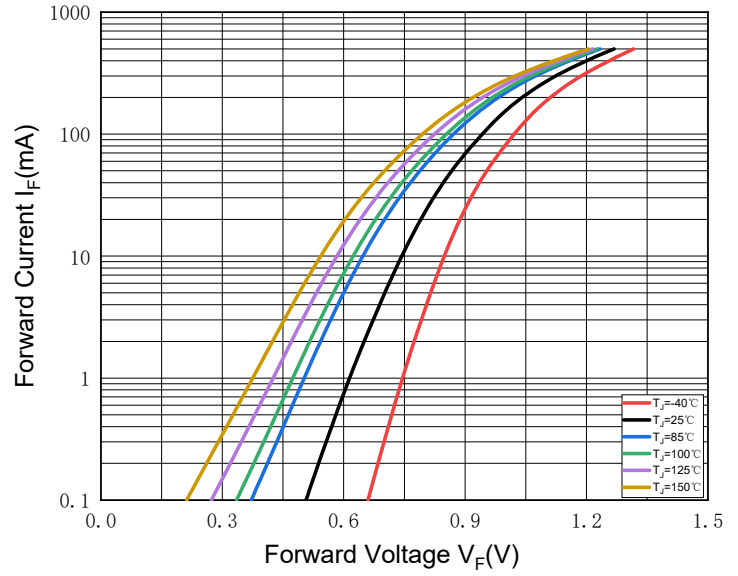

Fig.3: Reverse Characteristics

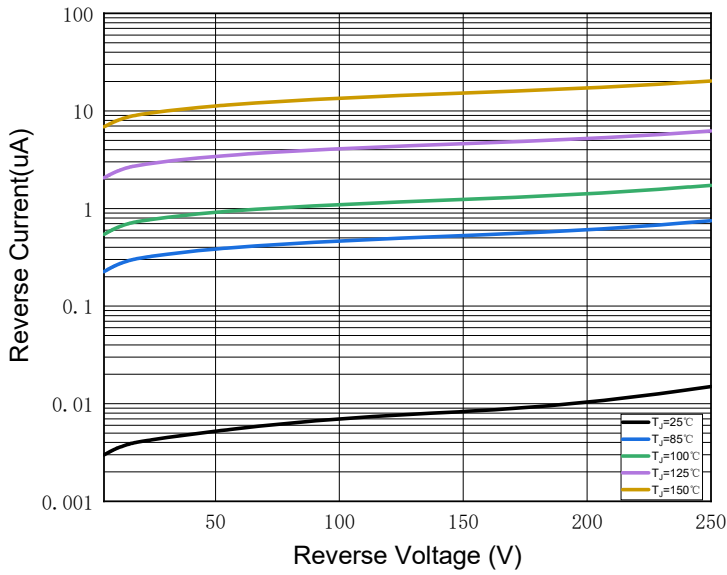
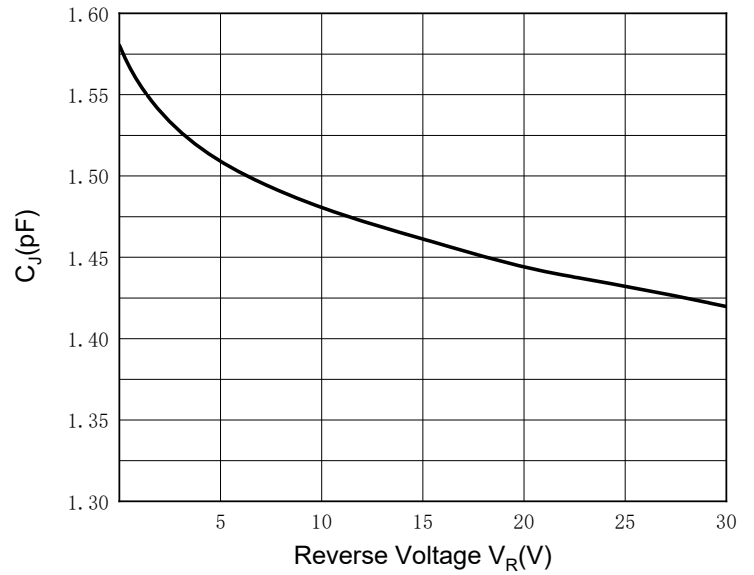

Fig.4: Capacitance Characteristics





BAV19WQ THRU BAV21WQ

■ Outline Dimensions

SOD-123

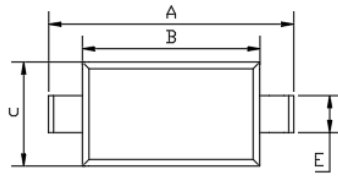

TOP VIEW

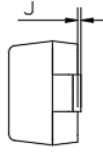

SIDE VIEW

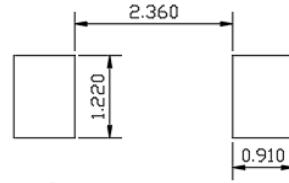

UNIT: mm

SUGGESTED SOLDER PAD LAYOUT

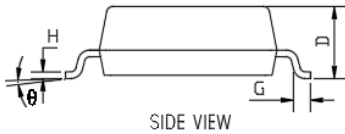

SIDE VIEW

DIMENSIONS				
DIM	INCHES		MM	
	MIN	MAX	MIN	MAX
A	0.140	0.152	3.550	3.850
B	0.100	0.112	2.550	2.850
C	0.055	0.071	1.400	1.800
D	0.037	0.053	0.950	1.350
E	0.020	0.028	0.510	0.710
G	0.006	0.018	0.150	0.450
H	0.003	0.010	0.080	0.250
J	0.000	0.006	0.000	0.150
θ	0	8°	0	8°

■ Marking Information

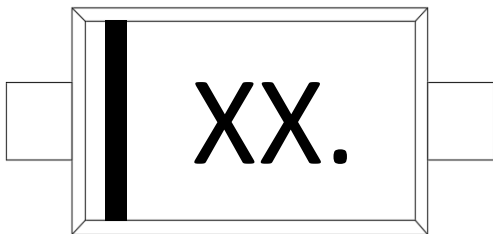

PN	Marking
BAV19WQ	A8
BAV20WQ	T2
BAV21WQ	T3

Note:

1. All marking is at middle of the product body
2. All marking is in laser marking
3. Body color: Black



BAV19WQ THRU BAV21WQ

Disclaimer

The information presented in this document is for reference only. Yangzhou Yangjie Electronic Technology Co., Ltd. reserves the right to make changes without notice for the specification of the products displayed herein to improve reliability, function or design or otherwise.

The product listed herein is designed to be used with automotive electronics, are not designed for use in medical, life-saving, life-sustaining, or military, Yangjie or anyone on its behalf, assumes no responsibility or liability for any damages resulting from such improper use of sale.

This publication supersedes & replaces all information previously supplied. For additional information, please visit our website [http:// www.21yangjie.com](http://www.21yangjie.com) , or consult your nearest Yangjie's sales office for further assistance.